

DIMENSIONS mm (inches)

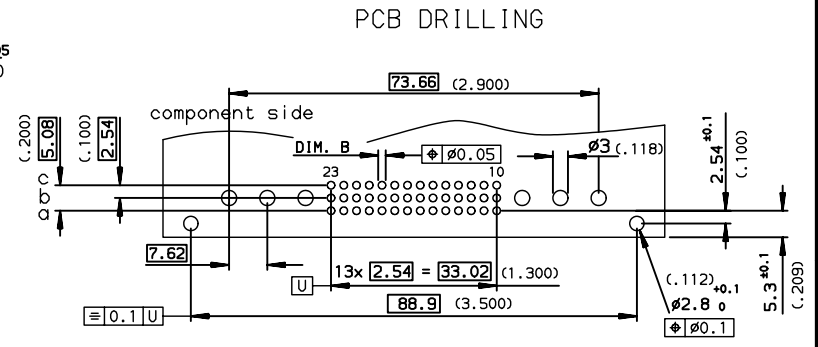
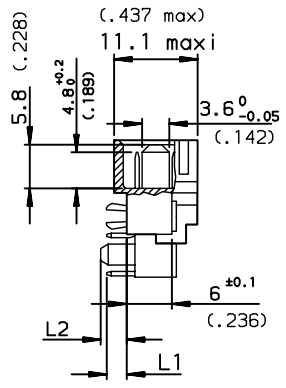
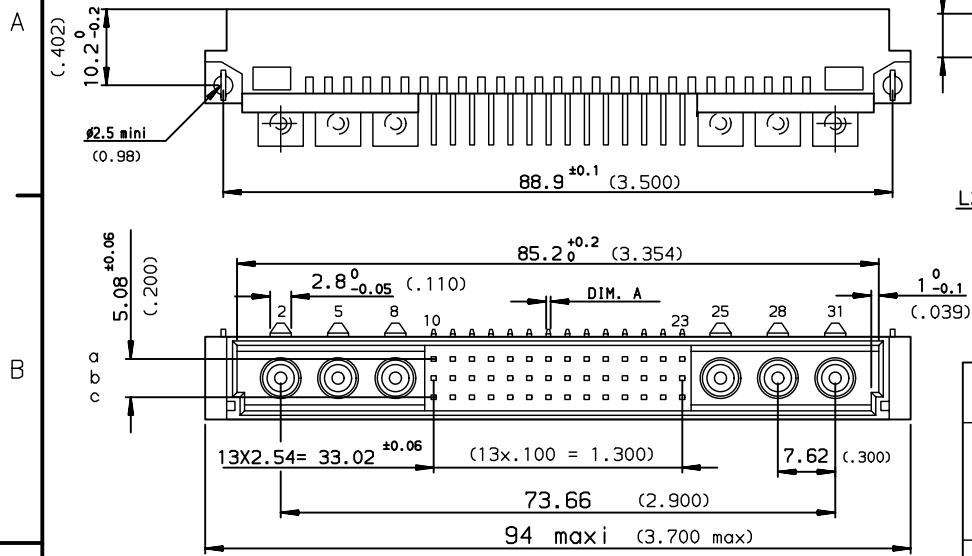

PART NUMBER	8609	EP	13	5
PIN OUT	rows a-b-c	3	42	
	rows a-c	4	28	
NUMBER OF CONTACTS				
TERMINATION	L1 = 2.75 ±0.15 (0.108)	A = $\varnothing 0.6 \pm 0.08$	B = $\varnothing 0.8 \pm 0.3$	13
	L2 = 3.40 ±0.2 (0.134)			
OPTIONS	no option			7
	with harpoons		for PCB thickness 1.6 mm	H
PERFORMANCE CLASS	DIN 41612 class 3			4
	DIN 41612 class 2			5
	DIN 41612 class 1			6
TERMINATION TYPE	TIN LEAD			000E1
	LEAD FREE			E1LF

GENERAL CHARACTERISTICS and ROHS INFORMATIONS  
SEE DRAWING C-8609-0000A

European Views

rev	ecn no	dr	date
A	-	ROU	1997/09/22
B	LS07-0130	HLE	2007/06/04
C	LS07-0211	HLE	2007/08/09
-	-	-	-
-	-	-	-
-	-	-	-

www.fciconnect.com		surface ISO 1302 <input checked="" type="checkbox"/>	tolerance std ISO 406 ISO 1101	projection 	mm
TOLERANCES UNLESS OTHERWISE SPECIFIED					
Dr	ROUILLARD	1997/09/22	ANGULAR	0.x ±0.1	size A3
Eng	ROUILLARD	1997/09/22	LINEAR	0.xx ±0.1	Scale 1.5
Chr	LEGARE	1997/09/22	0.xx' ±2'	0.xxx ±0.1	ECN LS07-0211
Appr	LEGARE	1997/09/22	Product family	DIN	Spec ref -
		title RIGHT ANGLE MALE STYLE M WITH POWER PINS FITTED		dwg no C-8609-0612	Rev. C
catalog no		SEE TABLE		CUSTOMER	sheet 1 of 1

Copyright FCJ.