

NOTES:

1.0 MATERIAL:

1.1 HOUSING: STAINLESS STEEL PER
ASTM-A-582 TYPE 303.

1.2 CENTER CONTACT: BERYLLIUM COPPER ROD
ALLOY C172, ASTM-B196.

1.3 DIELECTRIC: PTFE FLUOROCARBON PER
ASTM-D1457.

2.0 PLATING:

2.1 CENTER CONTACT: GOLD PER MIL-G-45204
TYPE II, CLASS 2.

3.0 MECHANICAL:

3.1 INTERFACE PER MIL-STD-348 IN ACCORDANCE
WITH MIL-A-55339.

3.2 CENTER CONTACT CAPTURED IN ACCORDANCE
WITH MIL-A-55339.

4.0 DIMENSIONS IN PARENTHESIS ARE MILLIMETERS.

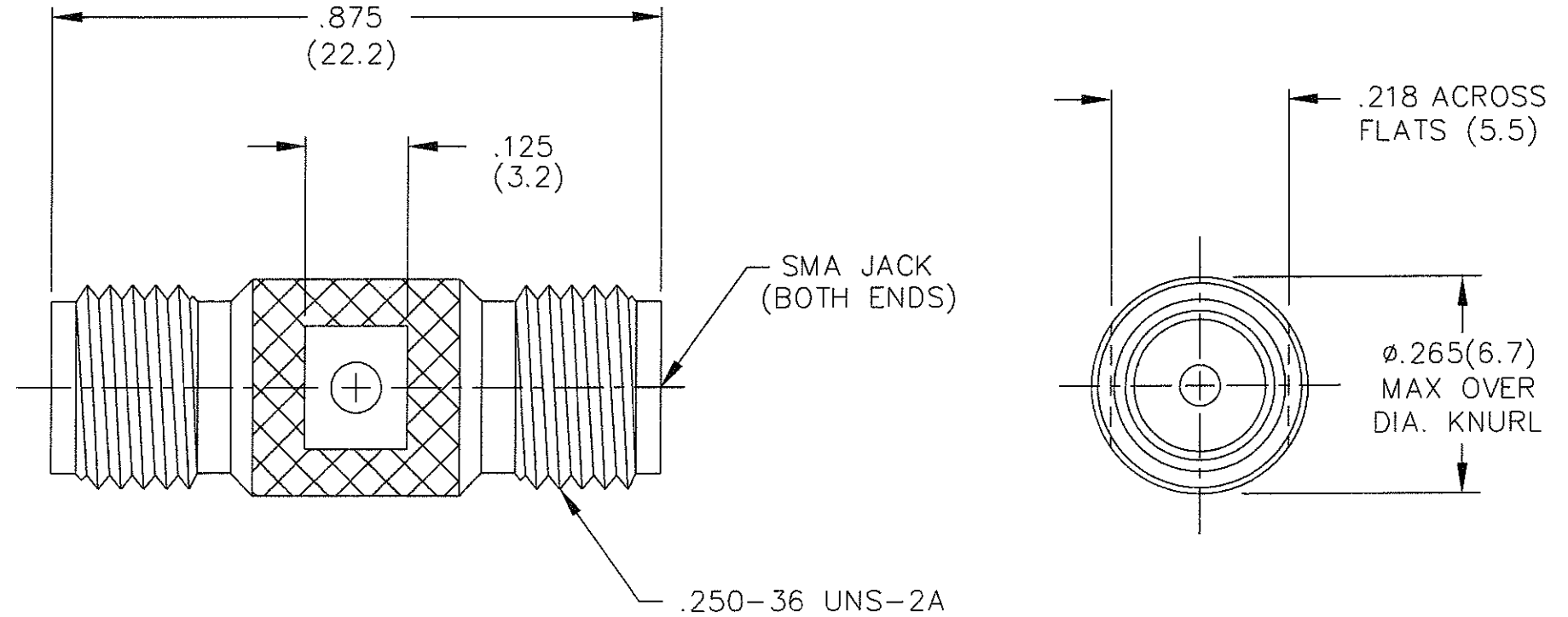

MODEL NUMBER
ADT-2841-FF-SMA-02

REV.
-1

DATE	1/31/97
DESCRIPTION	RELEASED
ADDED TITLEBLOCK	3/17/05
REV.	-1

UNLESS OTHERWISE NOTED DIMENSIONS ARE IN INCHES AND TOLERANCES ARE: 3 PLACE DECIMALS ±.005 2 PLACE DECIMALS ±.02 FRACTIONS ±1/64 PARALLELITY: T.I.R. _____ FLATNESS: T.I.R. _____ CONCENTRICITY: T.I.R. _____ ANGLES AND PERPENDICULARITY: ±1°	FSCM NO. 34078	MIDWEST MICROWAVE		
	NOTICE: The information contained in this drawing is proprietary and must not be used without the permission of Midwest Microwave		TITLE ADAPTER SAM JACK to SMA JACK	
	DRAWN/DATE L.BROWN 1/24/97	ENG./DATE G.KOZAK 1/30/97	DRAWING NUMBER ADT-2841-FF-SMA-02	
	CHECKED/DATE J.VERNON 1/27/97	APPROVED/DATE	SCALE: 5=1	SHEET 1 of 1