

ASSEMBLY - VIEW FROM FRONT

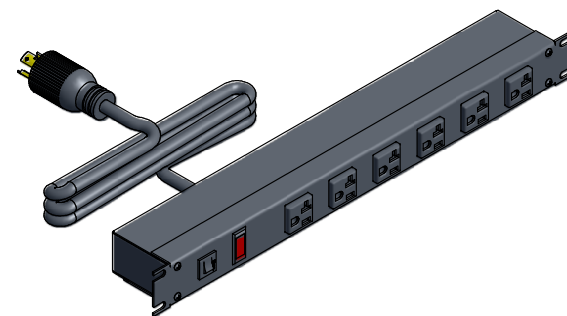

ISOMETRIC VIEW

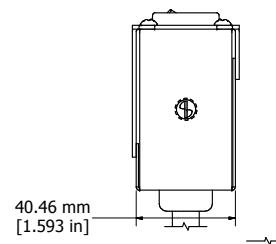
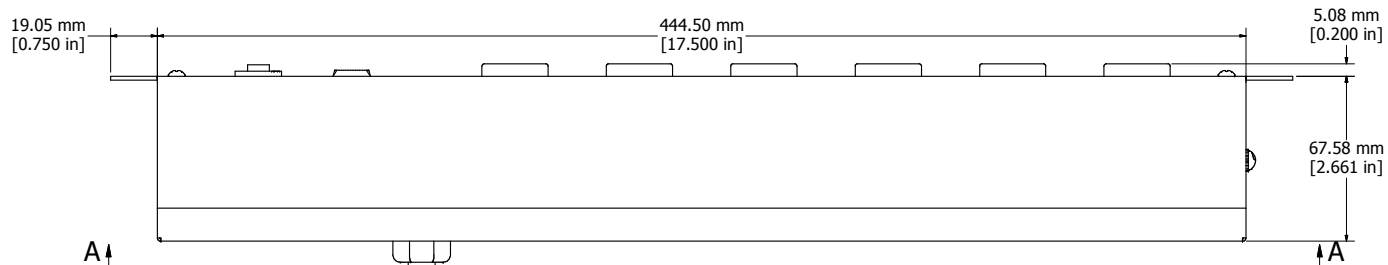

ASSEMBLY - VIEW FROM SIDE

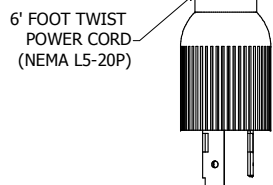

ASSEMBLY - VIEW FROM BOTTOM

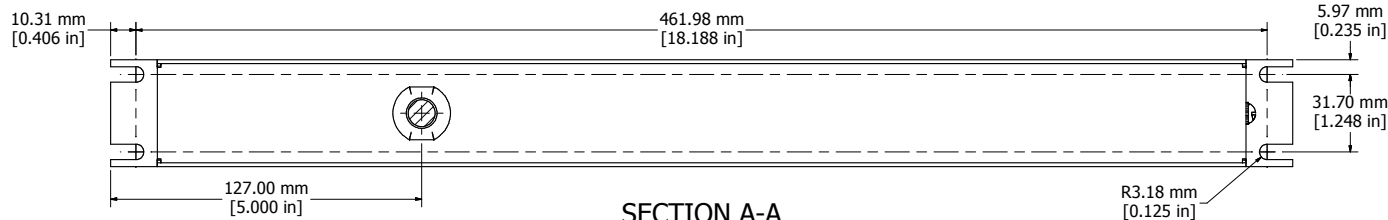

SECTION A-A

1589T6C1BKRF
Finish - Front - Black Painted Steel
Back - Black Painted Steel
Rated - 125 VAC, 60 Hz, 20 Amps
Approvals - CSA Certified Standards C22.2 (No. 21-95, 42-99)
- UL Recognized Standard UL1363
Cord Length
1589T6C1BKRF - 6' Foot Twist Power Cord (NEMA L5-20P)
1589T6D1BKRF - 15' Foot Twist Power Cord (NEMA L5-20P)



**HAMMOND
MANUFACTURING™**

1589T6C1BKRF

www.hammondmfg.com